

## Storage Baskets

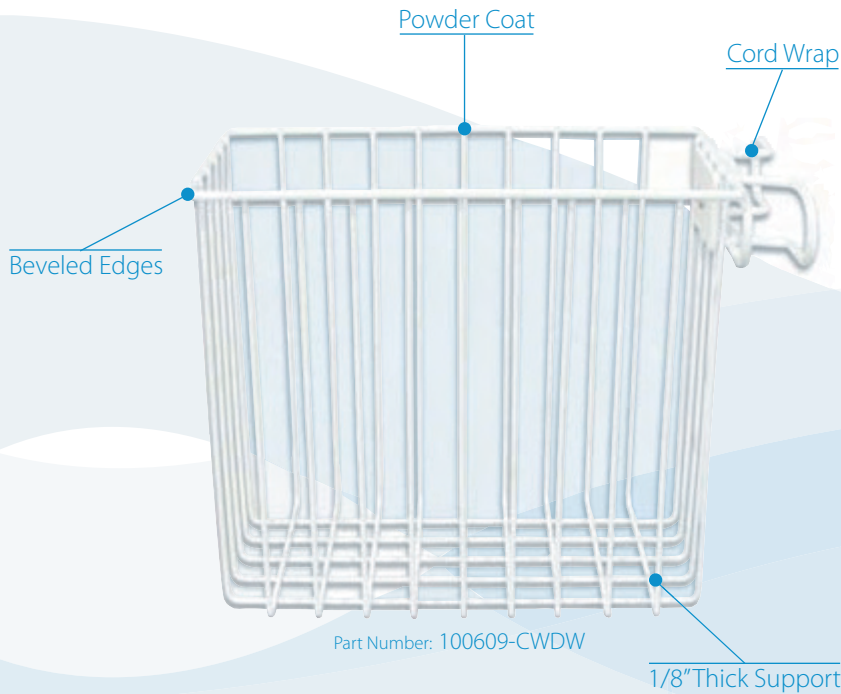

### Features:

- Easy to install
- Beveled safety edges
- Variety of mounting options
- Powder coated surface treatment
- Sizes range from 5" – 28" in length
- 1/8" steel wire construction

When considering Storage Solutions for healthcare facilities, Amico Accessories Baskets and Shelves are ideal. With the appropriate adapter, Storage Solutions can be used in any facility area to provide an esthetically pleasing equipment management solution.

## Storage Shelves

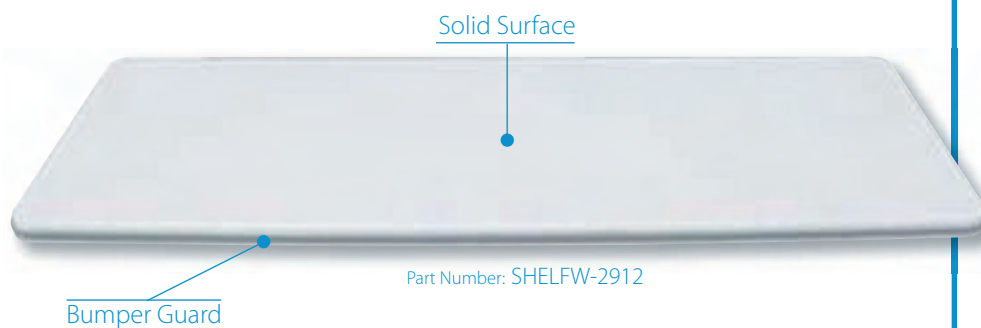

### Features:

- Folding and swivel capabilities
- Integrated bumper guard
- Variety of mounting options
- Holds weights up to 15lbs (7kg)
- Sizes range from 12" – 29" in length
- 12" depth

### Mounting Options

- A** Amico Horizontal Rail Mount  
(Compatible with Amico and Modular)
- V** Amico Vertical Rail Mount  
(Compatible with Amico and Modular)
- F** Fairfield Rail Mount (push button optional)
- E** DIN 25mm Rail Mount (30mm, 35mm optional)
- C** 1 1/4" Pole Mount
- M** Monitor Rail Mount
- D** Direct Wall Mount
- G** Vertical Rail Mount  
(Compatible with Amico, Modular and Hill Rom)
- S** HSI Mount-Vertical Rail Mount

Amico Accessories Baskets include the adapters required for the above rail systems.

### Swivel Mounted

The addition of a swivel adapter allows baskets to move side to side. Baskets hook around the top of the swivel adapter and can easily be removed for transferring or sterilizing.

### Top Mounted

The addition of two chrome plated steel supporting posts allows the baskets to be used above horizontal rail systems to accommodate various space restrictions.

### Bottom Mounted

Designed to sit below the center on any horizontal rail system, centered on a vertical rail system or mounted directly to any wall. Two adapters are used for baskets with lengths over 13" for added support.

## Swivel Storage Basket

9" x 9" x 10"

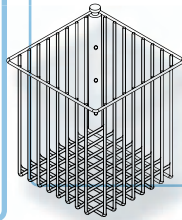

**A** 090910-A-BS

**V** 090910-V-BS

10" x 6" x 9"

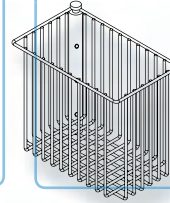

**A** 100609-A-BS

**V** 100609-V-BS

10" x 10" x 4"

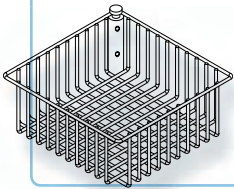

**A** 101004-A-BS

**V** 101004-V-BS

10" x 10" x 7"

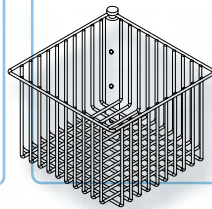

**A** 101007-A-BS

**V** 101007-V-BS

13" x 9" x 7"

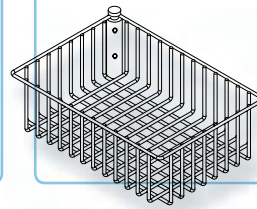

**A** 130907-A-BS

**V** 130907-V-BS

## Top Mounted

18" x 9" x 7"

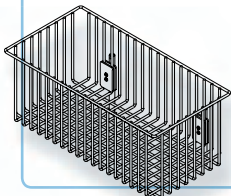

**A** 180907-A-BT

**F** 180907-F-BT

**E** 180907-E25-BT

\*17 13/16" between centers of two mounting plates

19" x 5" x 3"

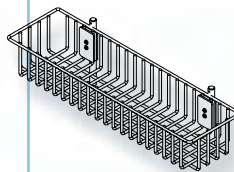

**A** 190503-A-BT

**F** 190503-F-BT

**E** 190503-E25-BT

\*17 13/16" between centers of two mounting plates

24" x 5" x 3"

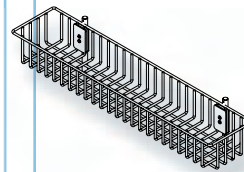

**A** 240503-A-BT

**F** 240503-F-BT

**E** 240503-E25-BT

\*22 5/16" between centers of two mounting plates

24 x 9" x 7"

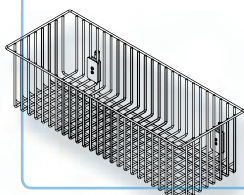

**A** 240907-A-BT

**F** 240907-F-BT

**E** 240907-E25-BT

\*22 5/16" between centers of two mounting plates

28" x 5" x 3"

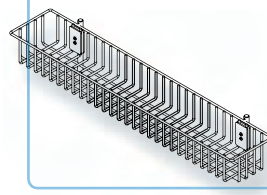

**A** 280503-A-BT

**F** 280503-F-BT

**E** 280503-E25-BT

\*26 13/16" between centers of two mounting plates

28 x 5" x 6"

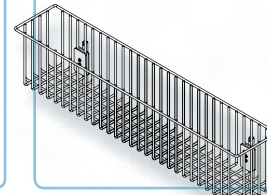

**A** 280506-A-BT

**F** 280506-F-BT

**E** 280506-E25-BT

\*26 13/16" between centers of two mounting plates

# Bottom Mounted

5" x 5" x 4"

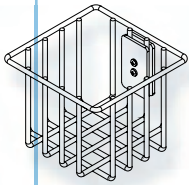

- (A)** 050504-A-BB
- (V)** 050504-V-BB
- (F)** 050504-F-BB
- (E)** 050504-E25-BB
- (C)** 050504-R125-BB
- (G)** 050504-G-BB
- (S)** 050504-S-BB
- (M)** 050504-MON-BB
- (D)** 050504-DW

9" x 9" x 10"

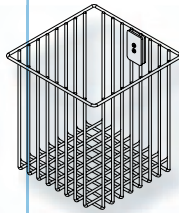

- (A)** 090910-A-BB
- (V)** 090910-V-BB
- (F)** 090910-F-BB
- (E)** 090910-E25-BB
- (C)** 090910-R125-BB
- (G)** 090910-G-BB
- (S)** 090910-S-BB
- (M)** 090910-MON-BB
- (D)** 090910-DW

10" x 6" x 9"

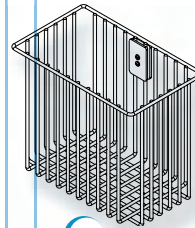

- (A)** 100609-A-BB
- (V)** 100609-V-BB
- (F)** 100609-F-BB
- (E)** 100609-E25-BB
- (C)** 100609-R125-BB
- (G)** 100609-G-BB
- (S)** 100609-S-BB
- (M)** 100609-MON-BB
- (D)** 100609-DW

10" x 10" x 4"

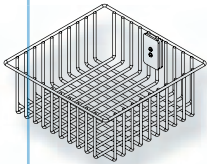

- (A)** 101004-A-BB
- (V)** 101004-V-BB
- (F)** 101004-F-BB
- (E)** 101004-E25-BB
- (C)** 101004-R125-BB
- (G)** 101004-G-BB
- (S)** 101004-S-BB
- (M)** 101004-MON-BB
- (D)** 101004-DW

10" x 10" x 7"

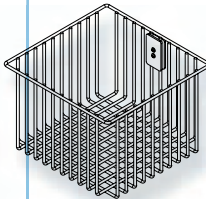

- (A)** 101007-A-BB
- (V)** 101007-V-BB
- (F)** 101007-F-BB
- (E)** 101007-E25-BB
- (C)** 101007-R125-BB
- (G)** 101007-G-BB
- (S)** 101007-S-BB
- (M)** 101007-MON-BB
- (D)** 101007-DW

13" x 9" x 7"

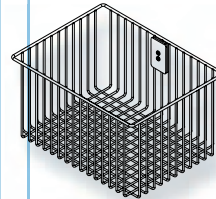

- (A)** 130907-A-BB
- (V)** 130907-V-BB
- (F)** 130907-F-BB
- (E)** 130907-E25-BB
- (C)** 130907-R125-BB
- (G)** 130907-G-BB
- (S)** 130907-S-BB
- (M)** 130907-MON-BB
- (D)** 130907-DW

\*Optional 14" plate for V-BB available (140907-V-BB)

18" x 9" x 7"

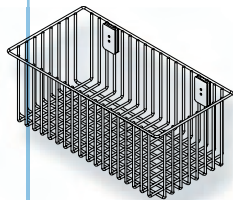

- (A)** 180907-A-BB
- (V)** 180907-V-BB
- (F)** 180907-F-BB
- (E)** 180907-E25-BB
- (D)** 180907-DW
- (G)** 180907-G-BB
- (S)** 180907-S-BB

19" x 5" x 3"

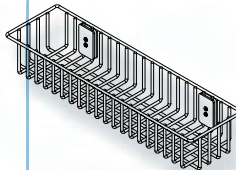

- (A)** 190503-A-BB
- (V)** 190503-V-BB
- (F)** 190503-F-BB
- (E)** 190503-E25-BB
- (D)** 190503-DW
- (G)** 190503-G-BB
- (S)** 190503-S-BB

24" x 5" x 3"

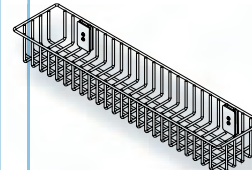

- (A)** 240503-A-BB
- (V)** 240503-V-BB
- (F)** 240503-F-BB
- (E)** 240503-E25-BB
- (D)** 240503-DW
- (G)** 240503-G-BB
- (S)** 240503-S-BB

\*17 13/16" between centers of two mounting plates

\*17 13/16" between centers of two mounting plates

\*22 5/16 between centers of two mounting plates

24 x 9" x 7"

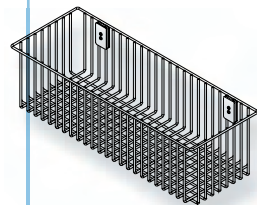

- (A)** 240907-A-BB
- (V)** 240907-V-BB
- (F)** 240907-F-BB
- (E)** 240907-E25-BB
- (D)** 240907-DW
- (G)** 240907-G-BB
- (S)** 240907-S-BB

28" x 5" x 3"

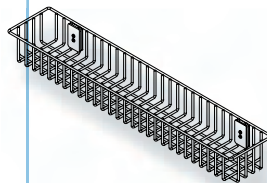

- (A)** 280503-A-BB
- (V)** 280503-V-BB
- (F)** 280503-F-BB
- (E)** 280503-E25-BB
- (D)** 280503-DW
- (G)** 280503-G-BB
- (S)** 280503-S-BB

28 x 5" x 6"

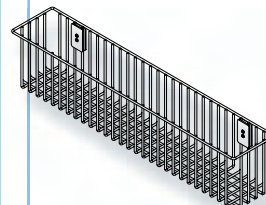

- (A)** 280506-A-BB
- (V)** 280506-V-BB
- (F)** 280506-F-BB
- (E)** 280506-E25-BB
- (D)** 280506-DW
- (G)** 280506-G-BB
- (S)** 280506-S-BB

\*22 5/16 between centers of two mounting plates

\*26 13/16" between centers of two mounting plates

\*26 13/16" between centers of two mounting plates

# Storage Shelves

## Swivel Writing Shelf (12" x 12")

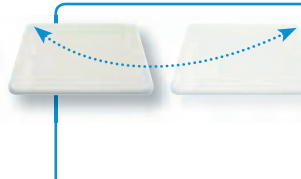

- Pivot action movement
- Includes a protective bumper
- Smooth surface for quick cleaning

**A** SHELFS-1212-A    **F** SHELFS-1212-F  
**V** SHELFS-1212-V    **E** SHELFS-1212-E1

## Folding Swivel Writing Shelf (12" x 12")



- Pivot action & folding down of shelf
- Includes a protective bumper
- Smooth surface for quick cleaning

**A** SHELFS-12FLD-A    **F** SHELFS-12FLD-F  
**V** SHELFS-12FLD-V    **E** SHELFS-12FLD-E1

## Folding Writing Shelf (29" x 12")



- Includes a protective bumper
- Smooth surface for quick cleaning
- Folds down when not in use

**A** SHELFW-29FLD-A    **F** SHELFW-29FLD-F  
**V** SHELFW-29FLD-V    **E** SHELFW-29FLD-E1

## Folding Writing Shelf (20" x 12")

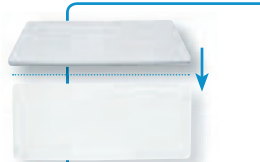

- Includes a protective bumper
- Smooth surface for quick cleaning
- Folds down when not in use

**A** SHELFW-20FLD-A    **F** SHELFW-20FLD-F  
**V** SHELFW-20FLD-V    **E** SHELFW-20FLD-E1

# Additional Accessories

## Cord Wraps



- Ideal for managing wires and cords
- Variety of mounting options

**A** CORDWRAP-A    **F** CORDWRAP-F    **D** CORDWRAP-DW  
**V** CORDWRAP-V    **E** CORDWRAP-E25    **G** CORDWRAP-G  
**C** CORDWRAP-R125    **M** CORDWRAP-MON    **S** CORDWRAP-S

## Basket Liners & Dividers

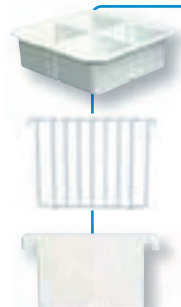

**10"x10"x4" Liner/Divider**  
 Part Number: DIV-1010-LNR

**Basket Divider for 9"x7" Baskets**  
 Part Number: DIV-0907

**Basket Divider for 5"x3" Baskets**  
 Part Number: DIV-0503

Please visit [www.amico.com](http://www.amico.com) for more information on other storage solutions.



## Distributed By:

